

744.018-6

Male connectors, conical male thread with outer hex

Type No.	Art. No.	Ø mm	F mm	a/f mm	a/f1 mm	D mm	E mm	L mm	P mm
744.018-4	108584	4	R 1/8	10	3	3.1	11.3	18.5	6.2
744.018-6	108585	6	R 1/8	12	4	4.1	13.5	22.5	6.2
744.018-8	108586	8	R 1/8	13	5	5.2	14.3	26.0	6.2
744.014-6	108587	6	R 1/4	12	4	4.1	13.2	22.3	8.5
744.014-8	108588	8	R 1/4	14	6	6.2	15.8	25.5	8.5
744.014-10	108589	10	R 1/4	16	7	7.2	17.7	28.9	8.5
744.038-8	108590	8	R 3/8	14	6	6.2	16.6	24.9	9.0
744.038-10	108591	10	R 3/8	16	7	7.2	17.7	28.9	9.0
744.038-12	108592	12	R 3/8	19	10	10.2	21.0	27.0	9.0
744.012-12	108593	12	R 1/2	19	10	10.2	21.3	26.6	11.0

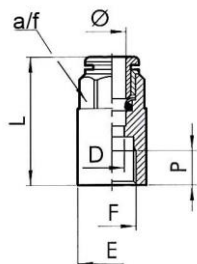

746.018-6

Male connectors, parallel female thread with outer hex

Type No.	Art. No.	Ø mm	F mm	a/f mm	P mm	L mm	D mm	E mm
746.005-3	108571	3	M5	7	4.5	15.7	2.5	7.8
746.018-4	108572	4	G 1/8	10	7.0	26.2	3.0	14.0
746.018-5	108573	5	G 1/8	12	7.0	27.5	4.0	14.0
746.018-6	108574	6	G 1/8	12	7.0	27.1	5.0	14.0
746.018-8	108575	8	G 1/8	13	7.0	28.1	7.0	14.0
746.014-4	108576	4	G 1/4	10	8.0	28.6	3.0	17.0
746.014-5	108577	5	G 1/4	12	8.0	29.5	4.0	17.0
746.014-6	108578	6	G 1/4	12	8.0	29.3	5.0	17.0
746.014-8	108579	8	G 1/4	14	8.0	30.0	7.0	17.0
746.014-10	108580	10	G 1/4	16	8.0	31.8	8.0	17.7
746.038-10	108581	10	G 3/8	16	10.0	36.8	8.0	20.8
746.038-12	108582	12	G 3/8	19	10.0	37.0	10.0	20.8
746.012-12	108583	12	G 1/2	19	11.0	40.5	10.0	23.8